

SERENUM

# Rex-PV

Solar Pumping Inverter



 [www.serenum.co.uk](http://www.serenum.co.uk)

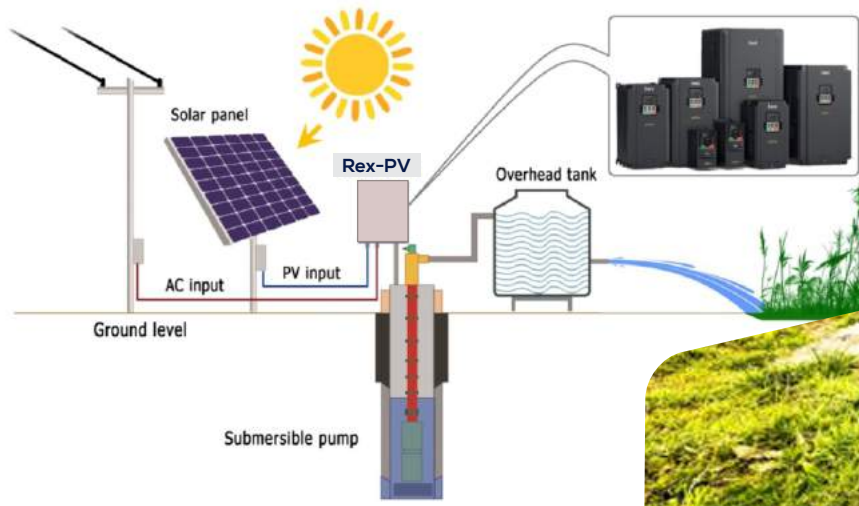

 [support@serenum.co.uk](mailto:support@serenum.co.uk)



# Products Features

- Cover voltage levels 220V AC and 380V AC; Support single-phase 220V and three-phase 220V/380V pumps, the power from 0.4kW to 37kW.
- Easy to use: The inverters automatically start or sleep only after being connected to solar battery panels without any parameter setting.
- Highly reliable for using multiple protective measures, including PV over-voltage protection, PV polarity reverse warning, and auto derating against over-temperature, which extend product life.
- Use advanced MPPT algorithms, ensuring that the solar power tracking efficiency reaches 99%.
- Models of 2.2kW or lower can be configured with the boost module, meeting low-voltage work requirements. This reduces the use of solar battery panels and therefore the cost.
- REX-PV series can implement auto switch between solar input and grid input by configuring the boost module or auto switching cabinet (meeting lightning protection requirements), implementing 24-hour unattended work.
- Support the configuration of the GPRS module, which implements remote parameter viewing and control by using the mobile APP.
- Support the cabinet solution for level IP54.

**Rex-PV**  
Solar Pumping Inverter

 [www.serenum.co.uk](http://www.serenum.co.uk)  
 [support@serenum.co.uk](mailto:support@serenum.co.uk)

# REX-PV – 5R5G – 4 5 – PV

①

②

③ ④

⑤

## Type Designation Key

Field identification	Sign	Detailed description of the sign	Detailed content
Product abbreviation	①	Product abbreviation	<b>REX-PV is short for Rex-PV</b>
Rated power	②	Power range + Load type	5R5G—5.5kW G— Constant torque load
Voltage degree	③	Voltage degree	4: AC 3PH 380V (-15%)~440(+10%) 2: AC 3PH 220V (-15%)~240(+10%) S2: AC 1PH 220V (-15%)~240(+10%) SS2: AC 1PH input/output 220V (-15%)~240(+10%)
Protection level	④	Protection level	Protection level 5—IP54 The protection level of a standard inverter is IP20, but this field is not displayed.
Industrial code	⑤	Industrial code	PV stands for PV pump.

## Product function parameters

## Products Specifications

Model	-SS2	-S2	-2	-4
Max. DC input voltage (V)	440	440	440	800
Start-up voltage (V)	200	200	200	300
Lowest working voltage (V)	150	150	150	250
Recommended DC input voltage range (V)	200~400	200~400	200~400	300~750
Recommended MPP voltage (V)	330	330	330	550
Rated output voltage (V)	220 (1PH)	220 (3PH)	220 (3PH)	380 (3PH)
Output frequency range (Hz)	0~400			
MPPT	99%			
Installation manner	Wall mounting/Rail mounting/Flange mounting			
Environment temperature	-10°C~+50°C If the ambient temperature of the inverter is above 40°C, derate 2% for every additional 1°C.			
Altitude	Below 1000m If the sea level is above 1000m, derate 1% for every additional 100m.			
Cooling manner	Forced cooling			
Protection level	IP20; IP54 (Cabinet)			



# Product rated specification parameters

Series	Model	Rated output power (kW)	Rated input current (A)	Rated output current (A)
-Ss2 series Single-phase, 220V input/output (0.4-2.2 kW)	REX-0R4G-SS2-PV	0.4	4.2	9
	REX-0R7G-SS2-PV	0.75	7.2	9
	REX-1R5G-SS2-PV	1.5	10.2	12
	REX-2R2G-SS2-PV	2.2	14	12
-S2 series Single-phase, 220V input (0.4-2.2 kW)	REX-0R4G-S2-PV	0.4	2.5	9
	REX-0R7G-S2-PV	0.75	4.2	9
	REX-1R5G-S2-PV	1.5	7.5	12
	REX-2R2G-S2-PV	2.2	10	12
-2 series Three-phase, 220V (4-7.5kW)	REX-1R5G-2-PV	1.5	7.5	12
	REX-2R2G-2-PV	2.2	10	12
	REX-004G-2-PV	4	16	20
-4 series Three-phase, 380V (0.75-37kW)	REX-5R5G-2-PV	5.5	20	30
	REX-7R5G-2-PV	7.5	30	40
	REX-0R7G-4-PV	0.75	2.5	9
	REX-1R5G-4-PV	1.5	4.2	9
	REX-2R2G-4-PV	2.2	5.5	12
	REX-004G-4-PV	4.0	9.5	16.5
	REX-5R5G-4-PV	5.5	14	23.9
	REX-7R5G-4-PV	7.5	18.5	30.6
	REX-011G-4-PV	11	25	39.2
	REX-015G-4-PV	15	32	49
	REX-018G-4-PV	18.5	38	50
	REX-022G-4-PV	22	45	60
	REX-030G-4-PV	30	60	81
	REX-037G-4-PV	37	75	90
	REX-045G-4-PV	45	92	130
	REX-055G-4-PV	55	115	150
	REX-075G-4-PV	75	150	200
	REX-090G-4-PV	90	180	250
	REX-110G-4-PV	110	215	300
	REX-132G-4-PV	132	260	360
REX-160G-4-PV	160	305	430	
REX-185G 4 PV	185	340	500	
REX-200G-4-PV	200	380	550	

# Installation Dimensions

0.4-2.2kW models support wall mounting and rail mounting:

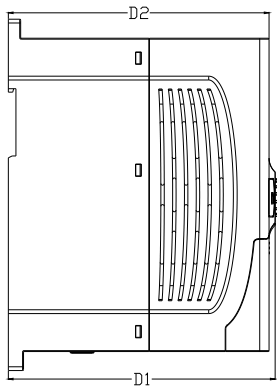
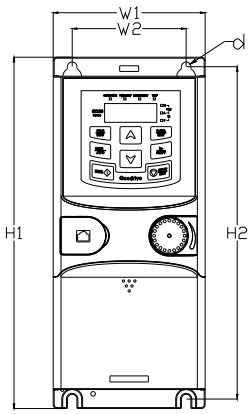

Dimensions in wall mounting (unit: mm)

Wall mounting

Model	W1	W2	H1	H2	D1	D2	Installation hole (d)
DEX-0R4G-S2-PV	80.0	60.0	160.0	150.0	123.5	120.3	5
DEX-0R7G-S2-PV	80.0	60.0	160.0	150.0	123.5	120.3	5
DEX-0R4G-SS2-PV	80.0	60.0	160.0	150.0	123.5	120.3	5
DEX-1R5G-S2-PV	80.0	60.0	185.0	175.0	140.5	137.3	5
DEX-2R2G-S2-PV	80.0	60.0	185.0	175.0	140.5	137.3	5
DEX-0R7G-SS2-PV	80.0	60.0	185.0	175.0	140.5	137.3	5
DEX-1R5G-SS2-PV	80.0	60.0	185.0	175.0	140.5	137.3	5
DEX-2R2G-SS2-PV	80.0	60.0	185.0	175.0	140.5	137.3	5
DEX-0R7G-4-PV	80.0	60.0	185.0	175.0	140.5	137.3	5
DEX-1R5G-4-PV	80.0	60.0	185.0	175.0	140.5	137.3	5
DEX-2R2G-4-PV	80.0	60.0	185.0	175.0	140.5	137.3	5

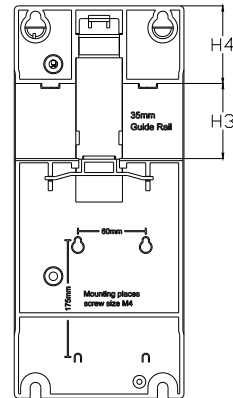
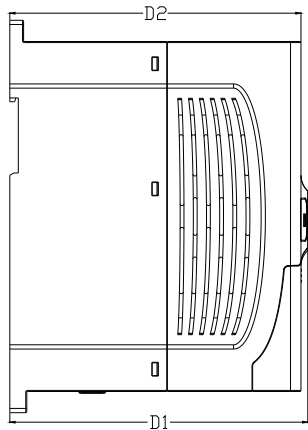
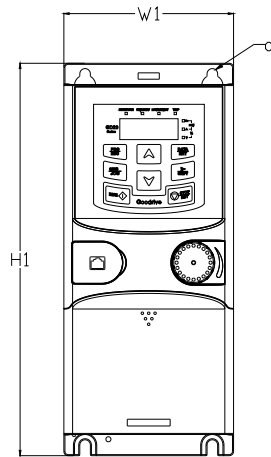

Dimensions in Rail mounting (unit: mm)

Rail mounting

Model	W1	H1	H3	H4	D1	D2	Installation hole (d)
REX-0R4G-S2-PV	80.0	160.0	35.4	36.6	123.5	120.3	5
REX-0R7G-S2-PV	80.0	160.0	35.4	36.6	123.5	120.3	5
REX-0R4G-SS2-PV	80.0	160.0	35.4	36.6	123.5	120.3	5
REX-1R5G-S2-PV	80.0	185.0	35.4	36.6	140.5	137.3	5
REX-2R2G-S2-PV	80.0	185.0	35.4	36.6	140.5	137.3	5
REX-0R7G-SS2-PV	80.0	185.0	35.4	36.6	140.5	137.3	5
REX-1R5G-SS2-PV	80.0	185.0	35.4	36.6	140.5	137.3	5
REX-2R2G-SS2-PV	80.0	185.0	35.4	36.6	140.5	137.3	5
REX-0R7G-4-PV	80.0	185.0	35.4	36.6	140.5	137.3	5
REX-1R5G-4-PV	80.0	185.0	35.4	36.6	140.5	137.3	5
REX-2R2G-4-PV	80.0	185.0	35.4	36.6	140.5	137.3	5



# Installation Dimentions

4-37kW models support wall mounting and flange mounting:

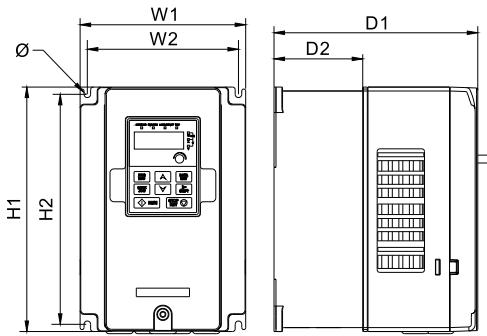

Dimensions in wall mounting (unit: mm)

Wall mounting

Model	W1	H1	H3	H4	D1	D2	Installation hole (d)
DEX-004G-4-PV	146.0	131.0	256.0	243.5	167.0	84.5	6
DEX-5R5G-4-PV	146.0	131.0	256.0	243.5	167.0	84.5	6
DEX-7R5G-4-PV	170.0	151.0	320.0	303.5	196.3	113.0	6
DEX-011G-4-PV	170.0	151.0	320.0	303.5	196.3	113.0	6
DEX-015G-4-PV	170.0	151.0	320.0	303.5	196.3	113.0	6
DEX-004G-2-PV	170.0	151.0	320.0	303.5	196.3	113.0	6
DEX-5R5G-2-PV	170.0	151.0	320.0	303.5	196.3	113.0	6
DEX-7R5G-2-PV	170.0	151.0	320.0	303.5	196.3	113.0	6
DEX-018G-4-PV	200.0	185.0	340.6	328.6	184.3	104.5	6
DEX-022G-4-PV	200.0	185.0	340.6	328.6	184.3	104.5	6
DEX-030G-4-PV	250.0	230.0	400.0	380.0	202.0	123.5	6
DEX-037G-4-PV	250.0	230.0	400.0	380.0	202.0	123.5	6

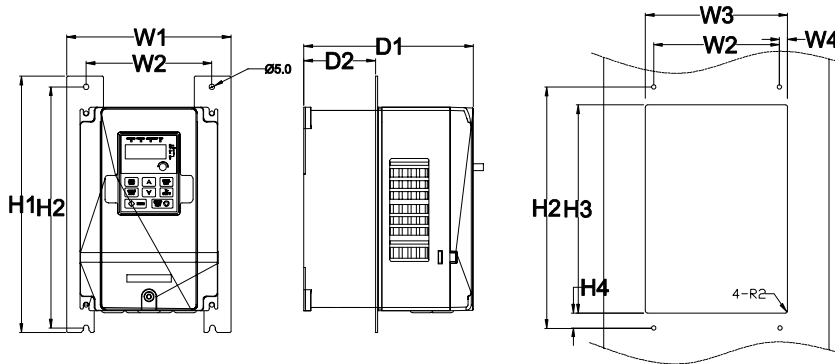

Dimensions in flange installation (unit: mm)

Flange installation

Model	W1	W2	W3	W4	H1	H2	H3	H4	D1	D2	Installation hole (d)	Nut specs
DEX-004G-4-PV	170.2	131	150	9.5	292	276	260	6	167	84.5	6	M5
DEX-5R5G-4-PV	170.2	131	150	9.5	292	276	260	6	167	84.5	6	M5
DEX-7R5G-4-PV	191.2	151	174	11.5	370	351	324	12	196.3	113	6	M5
DEX-011G-4-PV	191.2	151	174	11.5	370	351	324	12	196.3	113	6	M5
DEX-015G-4-PV	191.2	151	174	11.5	370	351	324	12	196.3	113	6	M5
DEX-004G-2-PV	191.2	151	174	11.5	370	351	324	12	196.3	113	6	M5
DEX-5R5G-2-PV	191.2	151	174	11.5	370	351	324	12	196.3	113	6	M5
DEX-7R5G-2-PV	191.2	151	174	11.5	370	351	324	12	196.3	113	6	M5
DEX-018G-4-PV	266	250	224	13	371	250	350.6	20.3	184.6	104	6	M5
DEX-022G-4-PV	266	250	224	13	371	250	350.6	20.3	184.6	104	6	M5
DEX-030G-4-PV	316	300	274	13	430	300	410	55	202	118.3	6	M5
DEX-037G-4-PV	316	300	274	13	430	300	410	55	202	118.3	6	M5

Note: If you use flange installation, you must configure flange installation boards. If you need inverters of greater power, contact INVT.

